

Courses & Dist^{cs}

N 87 W 86
 S 72 W 62
 S 56 W 90
 S 62 W 36
 S 81 W 30
 S 33 W 61 1/4
 N 67 E 370

1/2
 Juniatta

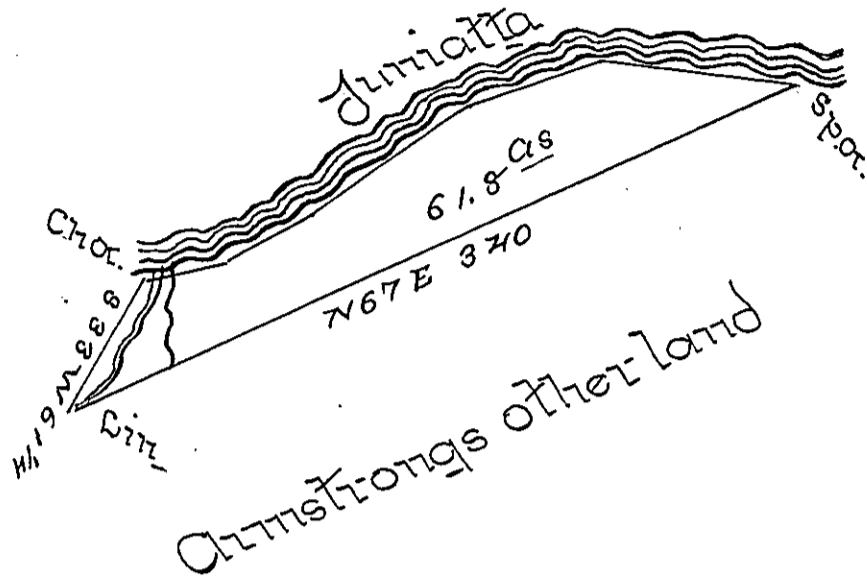

The Draught of a tract of land situate in Wayne Town-
 ship Cumberland County containing sixty one acres
 & eight tenths of an acre & the usual allowance of six
 per cent for roads &c. Surveyed for William Arm-
 strong May the 25th 1755 in pursuance of a Warrant
 from the Honorable the Proprietaries Dated Dec^r
 16th 1755 -

W^{ch} Jas Harris D.S.

John Birkens Esq^r Surv^r Gen^l -

IN TESTIMONY that the above is a copy of the original remaining on file in
 the Department of Internal Affairs of Pennsylvania, made
 conformably to an Act of Assembly approved the 16th day of
 February, 1833, I have hereunto set my Hand and caused
 the Seal of said Department to be affixed at Harrisburg,
 this fourth day of October 1898, -

James W. Latta
 Secretary of Internal Affairs.